

FD 960-22

CONTI® Double Convolution Air Spring

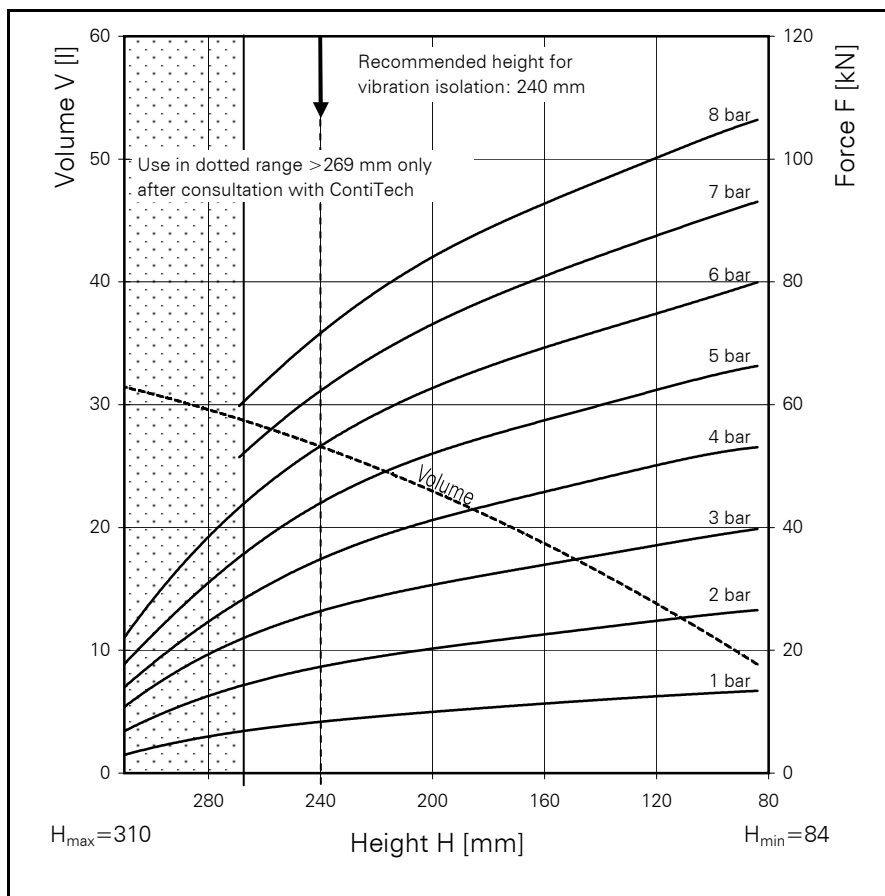
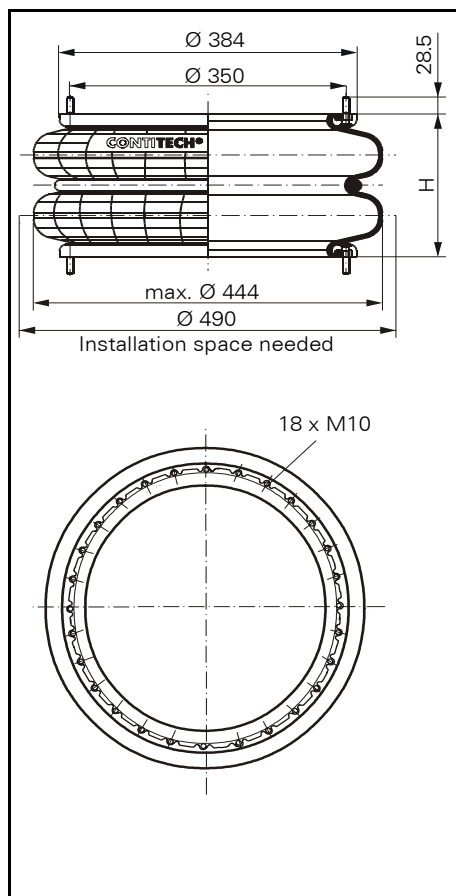

FD 960-22

Force-height diagram

Purchase order data

Type	Order No.
Rubber bellows only	61776
Bellows with bead rings 45mm bolts, nuts and washers	61903

Additional types on request

Technical data

Min. pressure	0 bar
Return force to min. height	≤ 200 N
Overall weight with clamped plates	8.6 kg

Vibration isolation - dynamic characteristic values

Design height H: recommended 240mm, minimum 220mm

Pressure p [bar]	3	4	5	6	7	8	Vol V [l]
Force (Load) [kN]	27.4	35.2	45.6	54.6	63.1	71.5	
Spring rate [N/cm]	3120	3900	4770	5600	6460	7310	
Natural frequency [Hz]	1.7	1.7	1.6	1.6	1.6	1.6	

Pneumatic application - static characteristic values

Force F [kN]

Pressure p [bar]	3	4	5	6	7	8	Vol.( l )	
Height H [mm]	220	28.7	38.1	48.2	58.1	68.2		78.5
	200	30.9	41.0	51.9	62.9	73.1		84.1
	180	32.2	43.8	54.8	66.2	77.2		88.6
	160	33.9	46.0	57.7	69.5	81.1		92.9
	140	35.5	47.6	59.8	71.9	84.3		96.5
	120	37.3	50.1	62.3	74.7	87.4		100.1
	100	38.6	52.2	64.8	77.8	90.8		103.9

Service instructions  
M 10 = 40 Nm