

6" x 1

PART NUMBER	TYPE	RUBBER	INLET
PNP 30405 02 00	Bellow	Standard	N/A
A 3 1330 01 01	Assembly	Standard	1/2" BSP
A 3 1472 0B 23	Bellow	Butyl	N/A
Contact Dunlop	Assembly	Butyl	1/2" BSP

Conditions of Use

Maximum Working Pressure	8bar
Burst Pressure	40bar
Maximum Angle between Top & Bottom Plates	5°
Maximum Axial Offset	10mm

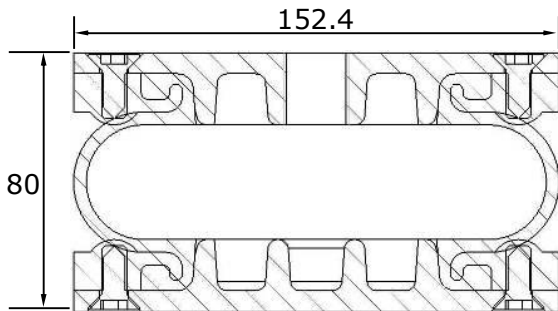

Precautions to Observe

- Do not exceed stated stroke.
- Do not inflate assembly when it is unrestricted.
- Do not inflate beyond pressures stated without prior consultation with Dunlop.
- Respect maximum and minimum heights.
- The bellows must be securely fixed.
- Do not use without air pressure.

Operating Temperature

Standard Rubber...

Minimum -30°C (-40°C Static)
Maximum +70°C (+90°C Static)

Chlorobutyl Rubber...

Minimum -25°C (-30°C Static)
Maximum +90°C (+115°C Static)

Materials

- Bellows : Various rubbers - 'Standard' and 'Chlorobutyl' (High Temperature)
- Metal parts : aluminium alloy

Note

This bellow assembly can be completely dismantled

Dimensions

Maximum Diameter	162mm
Space Required	180mm
Minimum Height	50mm
Maximum Height	110mm
Total Stroke	60mm
Static Height	80mm
Effective Area at Static Height	135cm ²
Bellows Weight	1.69kg

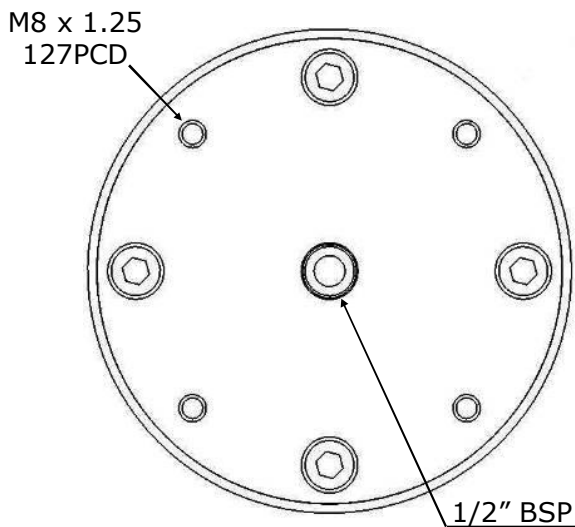

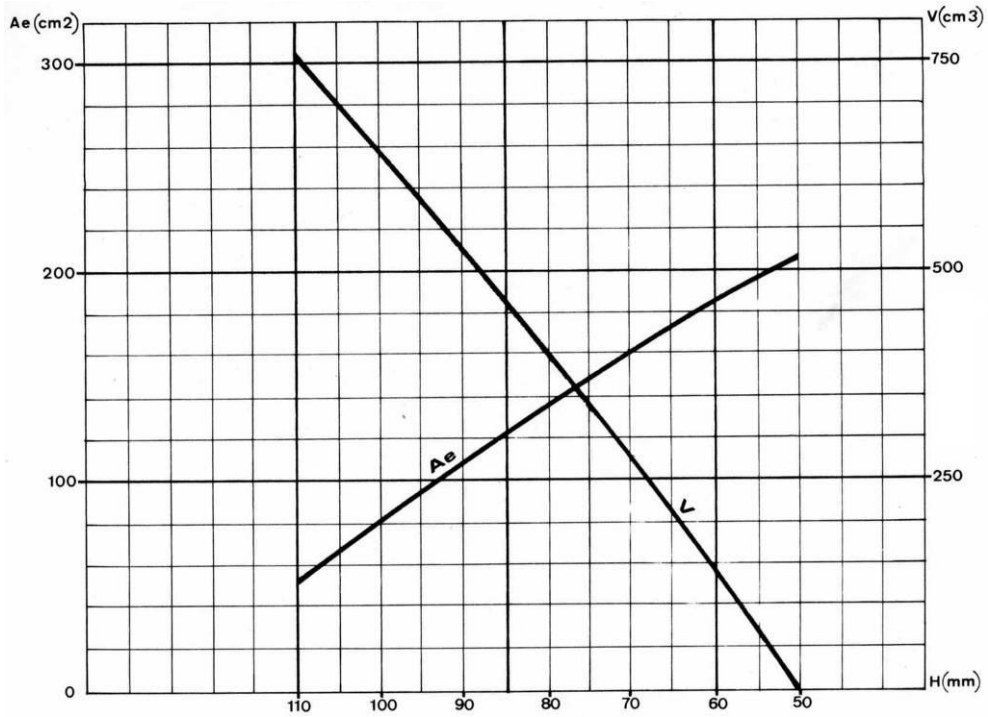

Ae : Effective Area
H : Spring Height
V : Volume

